

PI 474

**Attenzione: usare olio DOT4.** Si consiglia di usare una pompa freno con pistone da  $\varnothing 11$  a  $\varnothing 13$ .  
**Attention: use only DOT4 oil.** Use a brake pump with piston from  $\varnothing 11$  to  $\varnothing 13$ .  
**Attention: utiliser seulement huile DOT4.** On recommande d'utiliser une pompe frein avec piston de  $\varnothing 11$  à  $\varnothing 13$ .  
**Atención: usar solo aceite DOT4.** Se aconseja usar una bomba de freno con pistón desde  $\varnothing 11$  a  $\varnothing 13$ .

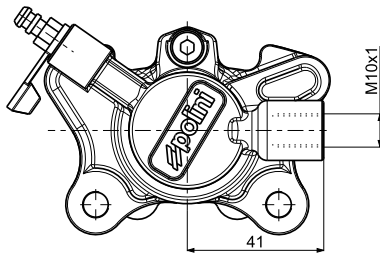

Coppia pastiglie freno cod. 050.2239 - Brake pads (pair):  
item 050.2239 - Couple plaquettes de frein réf.050.2239  
Pastillas de freno (copia): ref. 050.2239

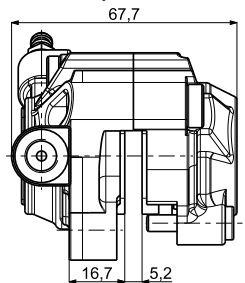
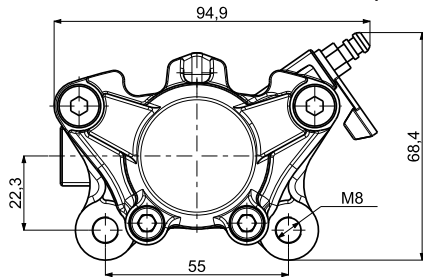
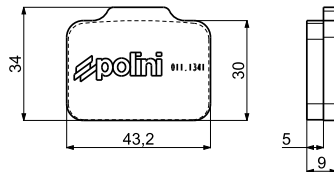

**polini**<sup>®</sup>  
motori  
*Trasforma il meglio in massimo.*